

**NOTICE!!**

**These documents have been scanned!**

**Do not place un-scanned documents beneath this notice!**

**Do not remove this notice from this file!**

GPO Jacket No. 560-102  
Print Order 61540  
Rise Business Services, LLC  
Job=AZ15 5/21/2019



Box Number= AZ15074



Claim Begin-End: AMC453446-AMC453455

**1 Initial Receipt**



AZ15074-29

AMC452850-AMC453499



**United States Department of the Interior**  
**Bureau of Land Management**  
 DIV OF LANDS, MINRLS & ENERGY  
 ONE N CENTRAL AVE  
 PHOENIX, AZ 85004 -4427  
 Phone: 602-417-9200

Receipt	
No:	4371763

**Transaction #:** 4489094  
**Date of Transaction:** 02/12/2019

CUSTOMER:	
	JOHN B PEMBERTON 4648 N PATSY DR KINGMAN,AZ 86409-2240 US

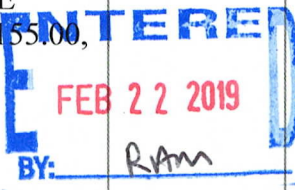
LINE #	QTY	DESCRIPTION	REMARKS	UNIT PRICE	TOTAL
1	10.00	LOCATABLE MINERALS / MINING CLAIMS-NEW,UNADJUD, ONE OR MORE AUTH NOS / NEW MINING CLAIM PROCESSING FEE <b>CASES:</b> AMC453446/\$20.00, AMC453447/\$20.00, AMC453448/\$20.00, AMC453449/\$20.00, AMC453450/\$20.00, AMC453451/\$20.00, AMC453452/\$20.00, AMC453453/\$20.00, AMC453454/\$20.00, AMC453455/\$20.00		- n/a -	200.00
2	10.00	LOCATABLE MINERALS / MINING CLAIMS-NEW,UNADJUD, ONE OR MORE AUTH NOS / NEW MINING CLAIMS LOCATION FEE <b>CASES:</b> AMC453446/\$37.00, AMC453447/\$37.00, AMC453448/\$37.00, AMC453449/\$37.00, AMC453450/\$37.00, AMC453451/\$37.00, AMC453452/\$37.00, AMC453453/\$37.00, AMC453454/\$37.00, AMC453455/\$37.00		- n/a -	370.00
3	10.00	LOCATABLE MINERALS / MINING CLAIMS-NEW,UNADJUD, ONE OR MORE AUTH NOS / NEW MINING CLAIMS MAINTENANCE FEE <b>CASES:</b> AMC453446/\$155.00, AMC453447/\$155.00, AMC453448/\$155.00, AMC453449/\$155.00, AMC453450/\$155.00, AMC453451/\$155.00, AMC453452/\$155.00, AMC453453/\$155.00, AMC453454/\$155.00, AMC453455/\$155.00		- n/a -	1550.00
<b>TOTAL:</b>					<b>\$2,120.00</b>

PAYMENT INFORMATION	
NOTE: Items will appear on credit card statement as "Bureau of Land Mgmt CO".	
1	AMOUNT: 2120.00
	POSTMARKED: N/A

TYPE:	CREDIT CARD	RECEIVED:	02/12/2019
NAME:	, B P.O. BOX 2428 CORTARO AZ 858652 US		
CARD NO:	XXXXXXXXXXXX3329	AUTH CODE:	01311C
NAME ON CARD:	GEORGE A HAHN		
SIGNATURE:			

REMARKS

This receipt was generated by the automated BLM Collections and Billing System and is a paper representation of a portion of the official electronic record contained therein.



**NOTICE!!**

**These documents have been scanned!**

**Do not place un-scanned documents beneath this notice!**

**Do not remove this notice from this file!**

GPO Jacket No. 560-102  
Print Order 61540  
Rise Business Services, LLC  
Job=AZ15 5/21/2019



Box Number= AZ15074



Claim Begin-End: AMC453446-AMC453455

**2 Correspondence**



AZ15074-29

AMC452850-AMC453499



**NO  
DOCUMENTS  
FOUND**

NO DOCUMENTS FOUND  
NO DOCUMENTS FOUND

**NOTICE!!**

**These documents have been scanned!**

**Do not place un-scanned documents beneath this notice!**

**Do not remove this notice from this file!**

GPO Jacket No. 560-102  
Print Order 61540  
Rise Business Services, LLC  
Job=AZ15 5/21/2019



Box Number= AZ15074



Claim Begin-End: AMC453446-AMC453455

**3 Transfers**



AZ15074-29

AMC452850-AMC453499



**NO  
DOCUMENTS  
FOUND**

NO DOCUMENTS FOUND  
NO DOCUMENTS FOUND

**NOTICE!!**

**These documents have been scanned!**

**Do not place un-scanned documents beneath this notice!**

**Do not remove this notice from this file!**

GPO Jacket No. 560-102  
Print Order 61540  
Rise Business Services, LLC  
Job=AZ15 5/21/2019



Box Number= AZ15074



Claim Begin-End: AMC453446-AMC453455

**4 Annual Filings**



AZ15074-29

AMC452850-AMC453499



**NO  
DOCUMENTS  
FOUND**

NO DOCUMENTS FOUND  
NO DOCUMENTS FOUND

**NOTICE!!**

**These documents have been scanned!**

**Do not place un-scanned documents beneath this notice!**

**Do not remove this notice from this file!**

GPO Jacket No. 560-102  
Print Order 61540  
Rise Business Services, LLC  
Job=AZ15 5/21/2019



Box Number= AZ15074



Claim Begin-End: AMC453446-AMC453455

**5 Miscellaneous**



AZ15074-29

AMC452850-AMC453499



**NO  
DOCUMENTS  
FOUND**

NO DOCUMENTS FOUND  
NO DOCUMENTS FOUND

**NOTICE!!**

**These documents have been scanned!**

**Do not place un-scanned documents beneath this notice!**

**Do not remove this notice from this file!**

GPO Jacket No. 560-102  
Print Order 61540  
Rise Business Services, LLC  
Job=AZ15 5/21/2019



Box Number= AZ15074



Claim Begin-End: AMC453446-AMC453455

**6 Location Notices-Amendments and Supporting Documents**



AZ15074-29

AMC452850-AMC453499



# MINING CLAIM STATUS REPORT

Data Entered: 2/22/19 RAM

MTP Checked By: \_\_\_\_\_  
GEO Checked By: PER

LEAD SERIAL NUMBER: AMC 453446 thru AMC 453455

**NUMBER OF CLAIMS & TYPE:**

10 LODE  
\_\_\_\_ PLACER  
\_\_\_\_ ASSOCIATION PLACER  
\_\_\_\_ MILL SITE  
\_\_\_\_ TUNNEL SITE

**CHARGES:**

Processing Fee @ \$20 = \$ 200  
Location Fee @ \$37 = \$ 370  
Maintenance Fee @ \$155 = \$ 1550  
Add'l Maint Fee for Assoc Placer = \$ \_\_\_\_\_  
**SUBTOTAL** \$ 2120  
\_\_\_\_ Other Fees \$ \_\_\_\_\_  
\_\_\_\_ Other Fees \$ \_\_\_\_\_  
**TOTAL** \$ \_\_\_\_\_

TOTAL ACREAGE: \_\_\_\_\_ Per Claim  
(Placer Only)

NUMBER OF LOCATORS: 1

DOCUMENTS RECEIVED VIA: Over-the-Counter  Mail  TIMELY FILED: Yes  No

LEGAL DESCRIPTION: T 21N R 20W SEC 17, 20, 29  
T \_\_\_\_\_ R \_\_\_\_\_ SEC \_\_\_\_\_  
T \_\_\_\_\_ R \_\_\_\_\_ SEC \_\_\_\_\_  
T \_\_\_\_\_ R \_\_\_\_\_ SEC \_\_\_\_\_  
T \_\_\_\_\_ R \_\_\_\_\_ SEC \_\_\_\_\_

BLM  FOREST SERVICE  WILDERNESS AREA  SUBJ TO PL 359: Yes  No

SPLIT ESTATE: N/A  SX  PX  OTHER   
SRHA  Was proper Notice filed if located on SHRA Land? Yes  No

**RECONVEYED MINERALS ON BLM LAND REQUIRE OPENING ORDER FROM 1944 TO 1993:**

Open to Entry On \_\_\_\_\_ N/A

COMMENTS/STATUS: VOID  PARTIALLY VOID  PVT MINERALS  WITHDRAWN LANDS   
OTHER

Claimant acknowledges that portions of the following claim(s) site(s) may be void or voidable.

Printed Name of Claimant \_\_\_\_\_ Signature of Claimant \_\_\_\_\_

\*\*\*\*\*FINAL ADJUDICATION\*\*\*\*\*

DATE \_\_\_\_\_ INITIALS \_\_\_\_\_

OFFICIAL RECORDS OF MOHAVE COUNTY KRISTI BLAIR, COUNTY RECORDER



02/11/2019 09:20 AM Fee: \$10.00

PAGE: 1 of 2

2

LOCATION NOTICE FOR LODE MINING CLAIM

Amendment BLM Serial #

NOTICE IS HEREBY GIVEN that the ARABIAN lode mining claim has been located by JOHN PEMBERTON whose current mailing address is 4648 PATSY, KINGMAN, AZ 86409

BLM Date Stamp PHOENIX, ARIZONA 2019 FEB 12 A 9:58

RECEIVED PHOENIX, ARIZONA STATE OFFICE

The general course of this claim is N30E-S30W and it is situated in MOHAVE County, Arizona. This claim is 1500 feet in length and 600 feet in width.

20 Total Claim Acreage. This claim runs from the location monument on which this location notice is posted on the centerline of the claim approximately 10 feet in a N30E direction to the NE end line and 1490 feet in a S30W direction to the SW end line. This claim is marked by six monuments, one at each corner and one at the center of each end line of the claim.

The location monument on which this notice is posted is situated within Section 20, Township 21N, Range 20W, Gila Salt River Base and Meridian, Arizona and this claim encompasses portions of the following quarter section(s), section(s), Township(s) and Range(s) NE 1/4 SEC 20, T21N, R20W

Gila Salt River Base and Meridian, Arizona.

The locality of this claim with reference to some natural object or permanent monument and additional information (if any) concerning its locality are as follows: APPROXIMATELY 1000 FT SW OF THE NE CORNER OF SEC 20, T21N, R20W, NE ADJACENT TO PATENTED CLAIMS MS 3255. The above information is shown on the attached map.

DATED AND POSTED on the ground this 5th day of JANUARY, 20 19.

LOCATOR(s) AGENT

Print Name(s) JOHN PEMBERTON Signature(s) John Pemberton

Form MCF100 Revised July 2014

AMC453446



# T21N R20W GSR B&M Mohave County, Arizo

## Philadelphia Group Claims Location Map

scale  
1000 ft.

o = Location Monument

Section 17

Section 20

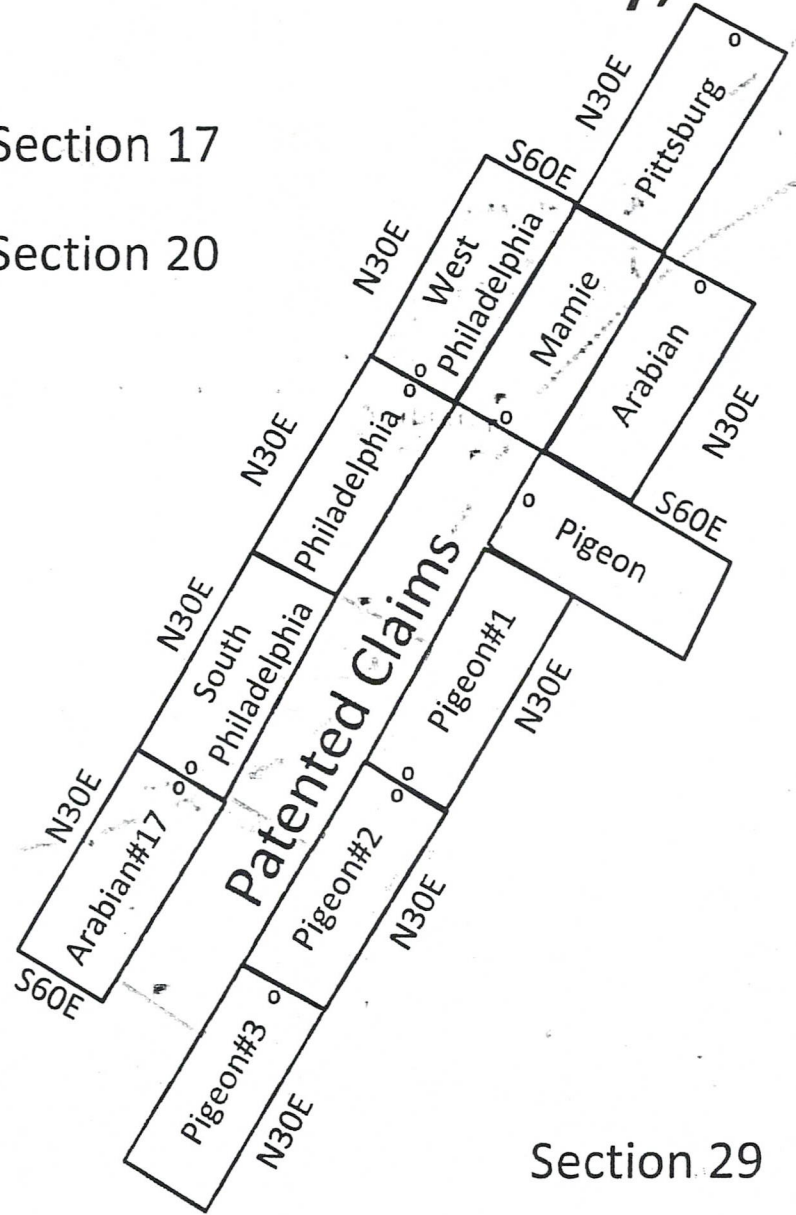

Section 19

Section 30

Section 29

PHOENIX, ARIZONA

FEB 12 2019 9:58

RECEIVED  
PLM AZ STATE OFFICE

AMC453446

Thumb  
Butte

OFFICIAL RECORDS OF MOHAVE COUNTY KRISTI BLAIR, COUNTY RECORDER



02/11/2019 09:20 AM Fee: \$10.00

PAGE: 1 of 2

2

LOCATION NOTICE FOR LODE MINING CLAIM

Amendment BLM Serial #

NOTICE IS HEREBY GIVEN that the ARABIAN #17 lode mining claim has been located by JOHN PEMBERTON whose current mailing address is 4648 PATSY, KINGMAN, AZ 86409

RECEIVED DIM A7 STATE OFFICE 2019 FEB 12 A 9:58 PHOENIX, ARIZONA BLM Date Stamp

The general course of this claim is N30E-S30W and it is situated in MOHAVE County, Arizona. This claim is 1500 feet in length and 600 feet in width.

20 Total Claim Acreage. This claim runs from the location monument on which this location notice is posted on the centerline of the claim approximately 10 feet in a N30E direction to the NE end line and 1490 feet in a S30W direction to the SW end line. This claim is marked by six monuments, one at each corner and one at the center of each end line of the claim.

The location monument on which this notice is posted is situated within Section 20, Township 21N, Range 20W, Gila Salt River Base and Meridian, Arizona and this claim encompasses portions of the following quarter section(s), section(s), Township(s) and Range(s) SW 1/4 SEC 20, T21N, R20W

Gila Salt River Base and Meridian, Arizona.

The locality of this claim with reference to some natural object or permanent monument and additional information (if any) concerning its locality are as follows: APPROXIMATELY 6200 FT. SW OF NE CORNER SEC 20, T21N, R20W, WEST ADJACENT TO PATENTED CLAIMS MS 3255. The above information is shown on the attached map.

DATED AND POSTED on the ground this 5th day of January, 2019.

LOCATOR(s) AGENT Print Name(s) JOHN PEMBERTON Signature(s) John Pemberton

Form MCF100 Revised July 2014

AMC453447



# T21N R20W GSR B&M Mohave County, Arizo

## Philadelphia Group Claims Location Map

scale  
  
1000 ft.

o = Location Monument

Section 17

Section 20

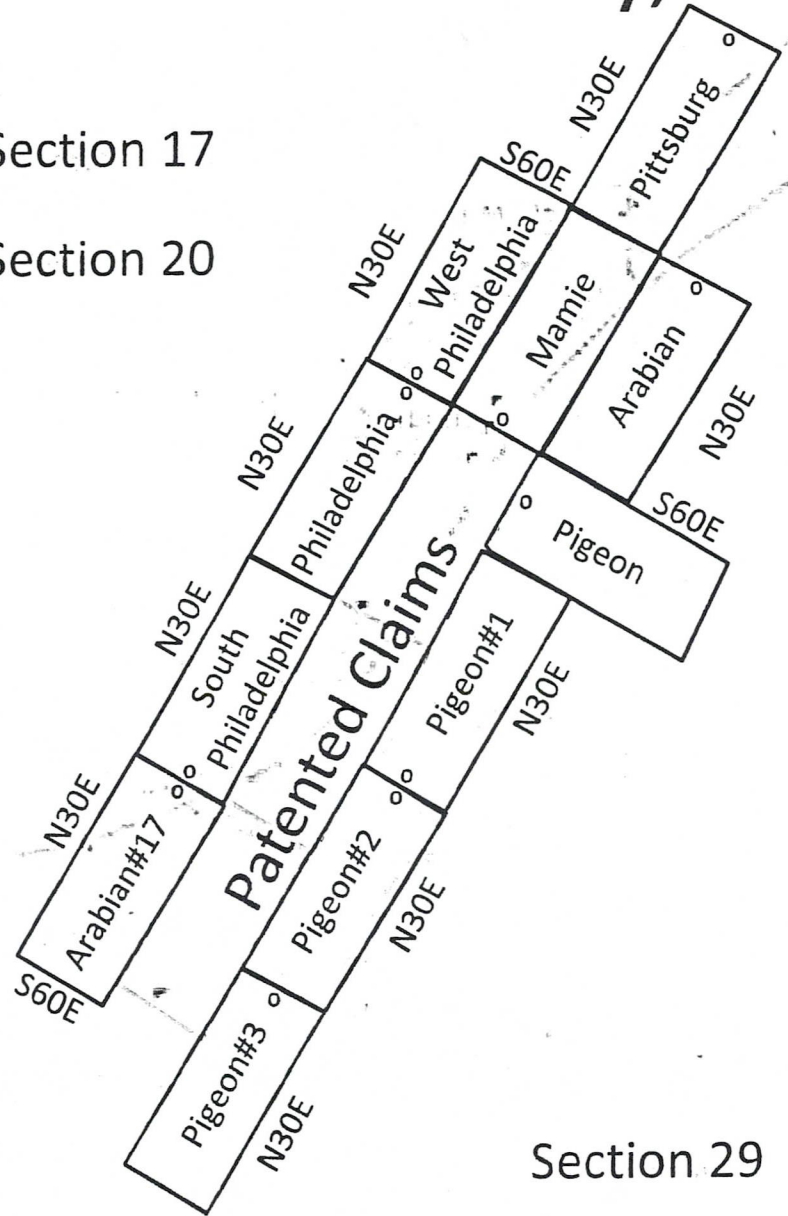

Section 19

Section 30

Section 29

RECEIVED  
PLM AZ STATE OFFICE  
2019 FEB 12 A 9 58  
PHOENIX, ARIZONA

AMC453447

Thumb  
Butte

OFFICIAL RECORDS OF MOHAVE COUNTY KRISTI BLAIR, COUNTY RECORDER



02/11/2019 09:20 AM Fee: \$10.00

2

LOCATION NOTICE FOR LOBE MINING CLAIM

Amendment BLM Serial #

NOTICE IS HEREBY GIVEN that the RITTSBURG

lobe mining claim has been located

by JOHN PEMBERTON whose current mailing

address is 4648 PATSY, KINGMAN, AZ 86409

RECEIVED RIM AZ STATE OFFICE 2019 FEB 12 A 9:58 PHOENIX, ARIZONA BLM Date Stamp

PAGE: 1 of 2

The general course of this claim is N30E-S30W and it is situated in MOHAVE

County, Arizona. This claim is 1500 feet in length and 600 feet in width.

20 Total Claim Acreage. This claim runs from the location monument on which this location notice is posted on the centerline of the claim approximately 10 feet in a NE direction to the NE end line and 1490 feet in a S30W direction to the SW end line. This claim is marked by six monuments, one at each corner and one at the center of each end line of the claim.

The location monument on which this notice is posted is situated within Section 17, Township 21N, Range 20 W, Gila Salt River Base and Meridian, Arizona and this claim encompasses portions of the following quarter section(s), section(s), Township(s) and Range(s) SE 1/4 SEC 17 and NE 1/4 SEC 20, T20N, R21W

Gila Salt River Base and Meridian, Arizona.

The locality of this claim with reference to some natural object or permanent monument and additional information (if any) concerning its locality are as follows: APPROXIMATELY 800 FT WEST OF SE CORNER SECTION 17, NE CORNER SECTION 20, T21N, R20W

The above information is shown on the attached map.

DATED AND POSTED on the ground this 5th day of JANUARY, 2019.

LOCATOR(s) AGENT

Print Name(s) JOHN PEMBERTON

Signature(s) John Pemberton

Form MCF100 Revised July 2014

AMC453448



# T21N R20W GSR B&M Mohave County, Arizona

## Philadelphia Group Claims Location Map

scale  
  
1000 ft.

o = Location Monument

Section 17

Section 20

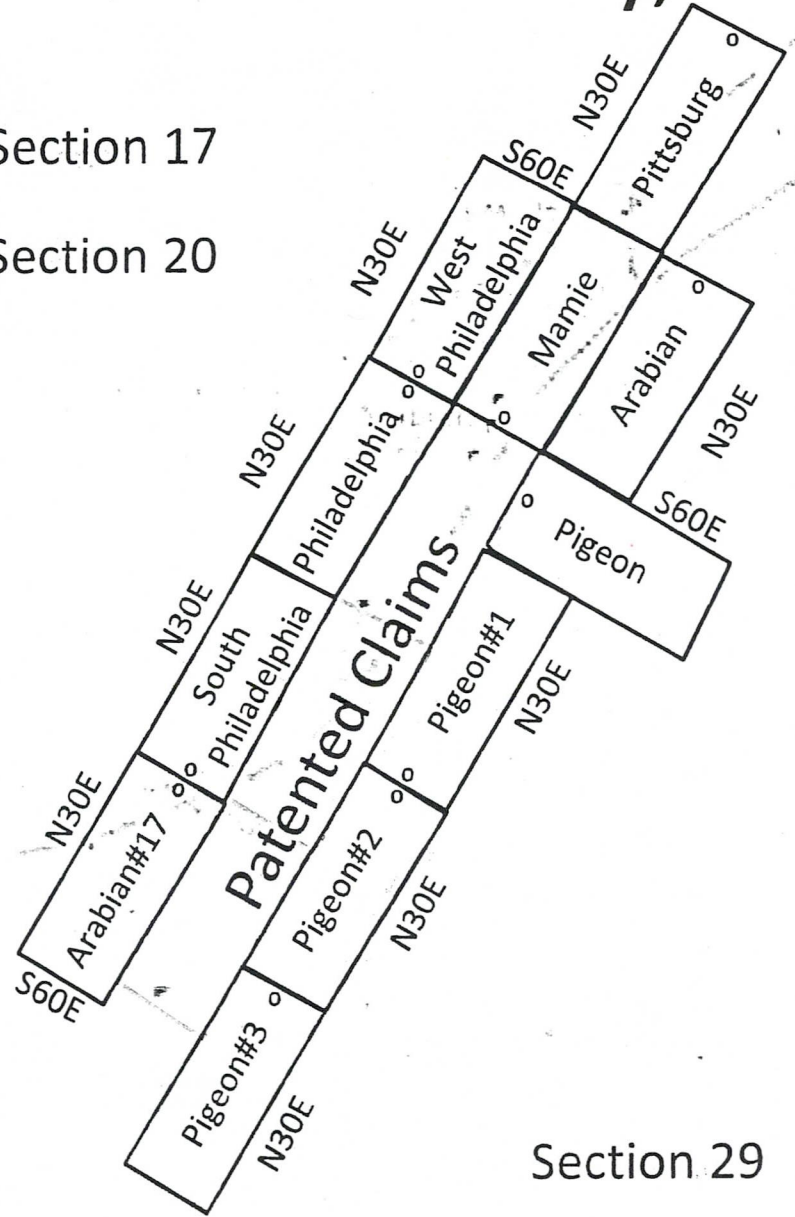

Section 19

Section 30

Section 29

PHOENIX, ARIZONA

2019 FEB 12 A 9:58

RECEIVED  
MILWAUKEE STATE OFFICE

Thumb  
Butte

AMC453448

OFFICIAL RECORDS OF MOHAVE COUNTY KRISTI BLAIR, COUNTY RECORDER



02/11/2019 09:20 AM Fee: \$10.00

PAGE: 1 of 2

2

LOCATION NOTICE FOR LODE MINING CLAIM

Amendment BLM Serial #

NOTICE IS HEREBY GIVEN that the PHILADELPHIA lode mining claim has been located by JOHN PEMBERTON whose current mailing address is 4648 PATSY, KINGMAN, AZ 86409

BLM Date Stamp PHOENIX, ARIZONA 2019 FEB. 12 A 9:58

RECEIVED M. A. Z. STATE OFFICE

The general course of this claim is N30E-S30W and it is situated in MOHAVE County, Arizona. This claim is 1500 feet in length and 600 feet in width.

20 Total Claim Acreage. This claim runs from the location monument on which this location notice is posted on the centerline of the claim approximately 10 feet in a N30E direction to the NE end line and 1490 feet in a S30W direction to the SW end line. This claim is marked by six monuments, one at each corner and one at the center of each end line of the claim.

The location monument on which this notice is posted is situated within Section 20, Township 21N, Range 20W, Gila Salt River Base and Meridian, Arizona and this claim encompasses portions of the following quarter section(s), section(s), Township(s) and Range(s) NE 1/4 and NW 1/4 SEC 20 T21N, R20W

Gila Salt River Base and Meridian, Arizona. The locality of this claim with reference to some natural object or permanent monument and additional information (if any) concerning its locality are as follows: APPROXIMATELY 3000 FT. SW OF NE CORNER SEC 20, T21N, R20W, WEST ADJACENT TO PATENTED CLAIMS MS 3285. The above information is shown on the attached map.

DATED AND POSTED on the ground this 5th day of JANUARY, 2019.

LOCATOR(s) AGENT

Print Name(s) JOHN PEMBERTON

Signature(s) John Pemberton

AMC453449

# T21N R20W GSR B&M Mohave County, Arizo

## Philadelphia Group Claims Location Map

scale  
  
1000 ft.

o = Location Monument

Section 17

Section 20

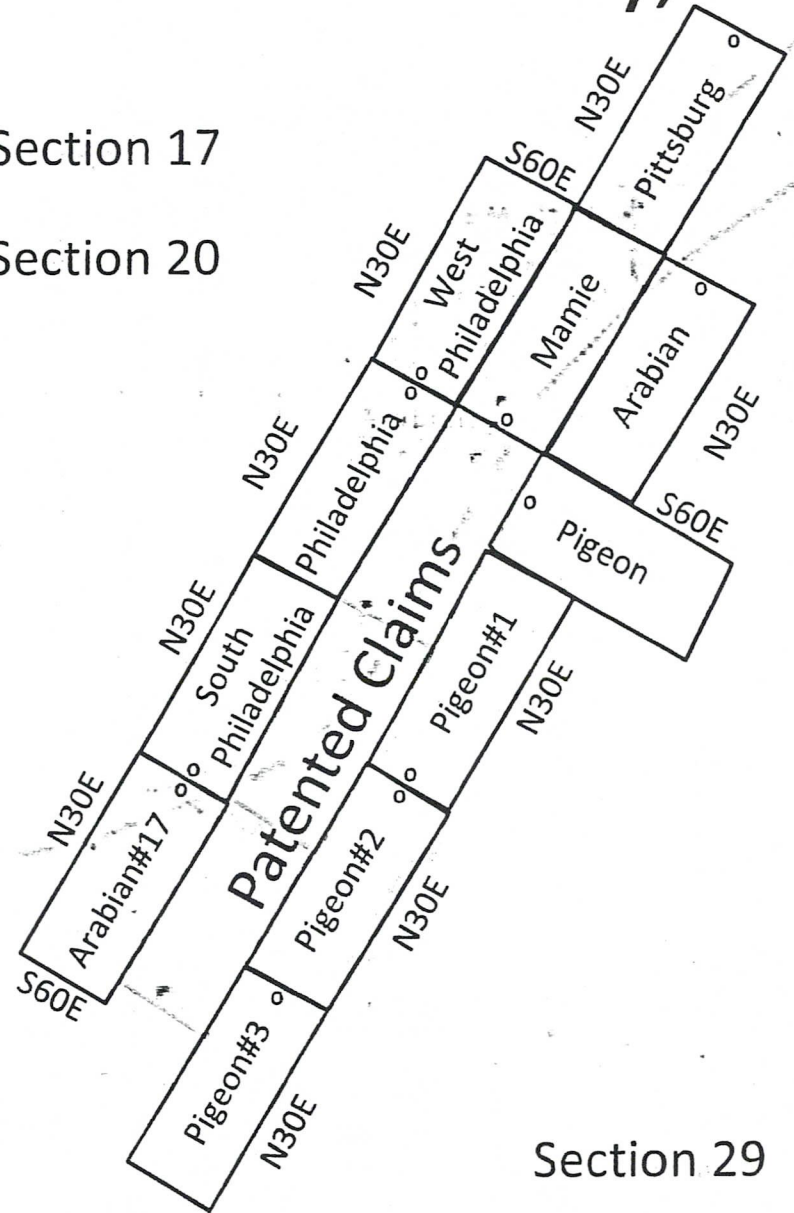

Section 19

Section 30

Section 29

PHOENIX, ARIZONA

RECEIVED  
FEB 12 4 58

RECEIVED  
FEB 12 4 58

RECEIVED  
FEB 12 4 58

RECEIVED  
FEB 12 4 58

Thumb  
Butte



OFFICIAL RECORDS OF MOHAVE COUNTY KRISTI BLAIR, COUNTY RECORDER



02/11/2019 09:20 AM Fee: \$10.00

PAGE: 1 of 2

RECEIVED PHOENIX, ARIZONA 2019 FEB 12 A 9:58

BLM Date Stamp

2

LOCATION NOTICE FOR LOBE MINING CLAIM

Amendment BLM Serial #

NOTICE IS HEREBY GIVEN that the SOUTH PHILADELPHIA lode mining claim has been located by JOHN PEMBERTON whose current mailing address is 4648 PATSY, KINGMAN, AZ 86409

The general course of this claim is N30E-S30W and it is situated in MOHAVE County, Arizona. This claim is 1500 feet in length and 600 feet in width.

20 Total Claim Acreage. This claim runs from the location monument on which this location notice is posted on the centerline of the claim approximately 10 feet in a S30W direction to the SW end line and 1490 feet in a N30E direction to the NE end line. This claim is marked by six monuments, one at each corner and one at the center of each end line of the claim.

The location monument on which this notice is posted is situated within Section 20, Township 21N, Range 20W, Gila Salt River Base and Meridian, Arizona and this claim encompasses portions of the following quarter section(s), section(s), Township(s) and Range(s) SW 1/4 and NW 1/4 SEC 20 T21N, R20W

Gila Salt River Base and Meridian, Arizona.

The locality of this claim with reference to some natural object or permanent monument and additional information (if any) concerning its locality are as follows: APPROXIMATELY 4700 FT. SW OF NE CORNER SEC 20, T21N, R20W, WEST ADJACENT TO PATENTED CLAIM, MS 3255. The above information is shown on the attached map.

DATED AND POSTED on the ground this 5th day of January, 2019.

LOCATOR(s) AGENT

Print Name(s) John Pemberton Signature(s) John Pemberton

Form MCF100 Revised July 2014

AMC453450

# T21N R20W GSR B&M Mohave County, Arizo

## Philadelphia Group Claims Location Map

scale  
  
1000 ft.

o = Location Monument

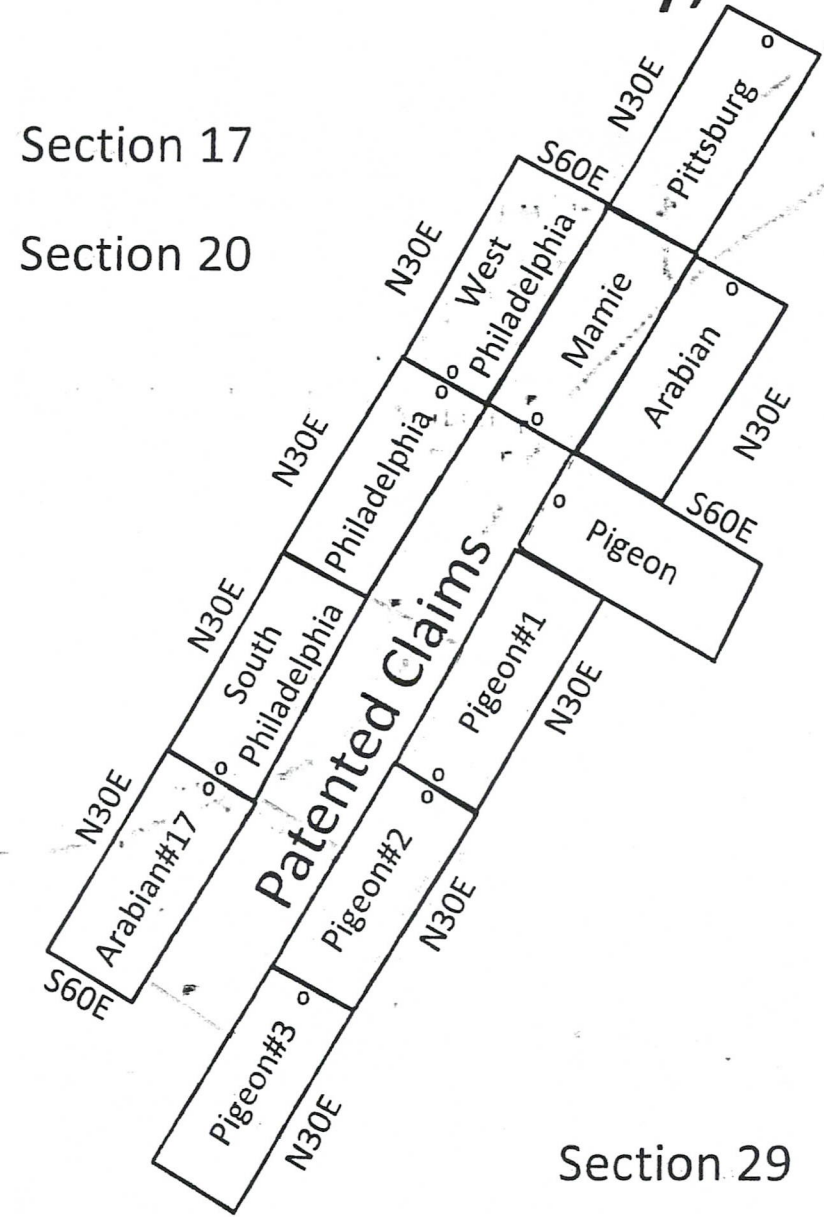

PHOENIX, ARIZONA

RECEIVED  
PHOENIX, ARIZONA  
2019 FEB 12 A 9:59

RECEIVED  
PHOENIX, ARIZONA  
2019 FEB 12 A 9:59

AMC453450

Thumb  
Butte



OFFICIAL RECORDS OF MOHAVE COUNTY KRISTI BLAIR, COUNTY RECORDER



02/11/2019 09:20 AM Fee: \$10.00

PAGE: 1 of 2

2

LOCATION NOTICE FOR LODE MINING CLAIM

Amendment BLM Serial #

NOTICE IS HEREBY GIVEN that the West Philadelphia lode mining claim has been located by John Pemberton whose current mailing address is 4648 Patsy, Kingman, AZ 86409

RECEIVED PHOENIX, ARIZONA 2019 FEB 12 A 9:59 BLM Date Stamp

The general course of this claim is N30E-S30W and it is situated in Mohave County, Arizona. This claim is 1500 feet in length and 600 feet in width.

20 Total Claim Acreage. This claim runs from the location monument on which this location notice is posted on the centerline of the claim approximately 10 feet in a S30W direction to the SW end line and 1490 feet in a N30E direction to the NE end line. This claim is marked by six monuments, one at each corner and one at the center of each end line of the claim.

The location monument on which this notice is posted is situated within Section 20, Township 21N, Range 20W, Gila Salt River Base and Meridian, Arizona and this claim encompasses portions of the following quarter section(s), section(s), Township(s) and Range(s) NE 1/4 SEC 20, SE 1/4 SEC 17 T21N, R20W

Gila Salt River Base and Meridian, Arizona. The locality of this claim with reference to some natural object or permanent monument and additional information (if any) concerning its locality are as follows: Approximately 2000 FT. WEST OF NE CORNER SEC 20, T21N, R20W, NW ADJACENT TO PATENTED CLAIMS MS 3255. The above information is shown on the attached map.

DATED AND POSTED on the ground this 5th day of JANUARY, 2019.

LOCATOR(s) AGENT

Print Name(s) John Pemberton Signature(s) John Pemberton

AMC453451



# T21N R20W GSR B&M Mohave County, Arizo

## Philadelphia Group Claims Location Map

scale  
  
1000 ft.

o = Location Monument

Section 17

Section 20

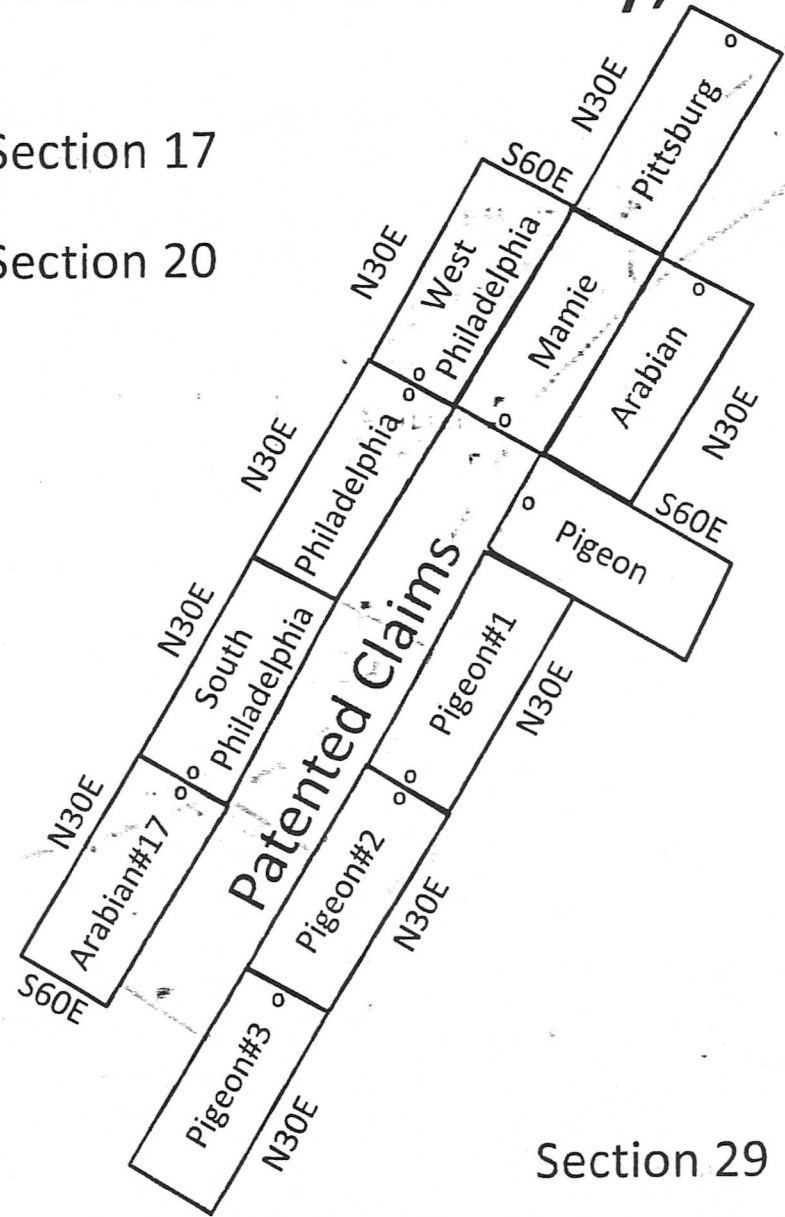

Section 19

Section 30

Section 29

PHOENIX, ARIZONA

2019 FEB 12 A 9: 59

RECEIVED  
P.M. AZ STATE OFFICE

AMC4534511

Thumb  
Butte

FEE# 2019006516

OFFICIAL RECORDS OF MOHAVE COUNTY KRISTI BLAIR, COUNTY RECORDER



02/11/2019 09:20 AM Fee: \$10.00

PAGE: 1 of 2

2

LOCATION NOTICE FOR LODE MINING CLAIM

Amendment BLM Serial #

NOTICE IS HEREBY GIVEN that the PIGEON lode mining claim has been located by John Pemberton whose current mailing address is 4648 PATSY KINGMAN, AZ 86409

BLM Date Stamp PHOENIX, ARIZONA 2019 FEB 12 A 9:59

RECEIVED D.M.A. STATE OFFICE

The general course of this claim is S60E-N60W and it is situated in MOHAVE County, Arizona. This claim is 1500 feet in length and 600 feet in width.

20 Total Claim Acreage. This claim runs from the location monument on which this location notice is posted on the centerline of the claim approximately 10 feet in a N60W direction to the NW end line and 1490 feet in a S60E direction to the SE end line. This claim is marked by six monuments, one at each corner and one at the center of each end line of the claim.

The location monument on which this notice is posted is situated within Section 20, Township 21N, Range 20W, Gila Salt River Base and Meridian, Arizona and this claim encompasses portions of the following quarter section(s), section(s), Township(s) and Range(s) NE 1/4 SEC 20, T21N R20W

Gila Salt River Base and Meridian, Arizona.

The locality of this claim with reference to some natural object or permanent monument and additional information (if any) concerning its locality are as follows: APPROXIMATELY 2700 FT. SW OF NE CORNER SECTION 20, T21N, R20W, EAST ADJACENT TO PATENTED CLAIMS MS 3255. The above information is shown on the attached map.

DATED AND POSTED on the ground this 5th day of JANUARY, 2019.

LOCATOR(s) AGENT Print Name(s) John Pemberton Signature(s) John Pemberton

Form MCF100 Revised July 2014

AMC453452

# T21N R20W GSR B&M Mohave County, Arizo

## Philadelphia Group Claims Location Map

scale  
  
1000 ft.

o = Location Monument

Section 17

Section 20

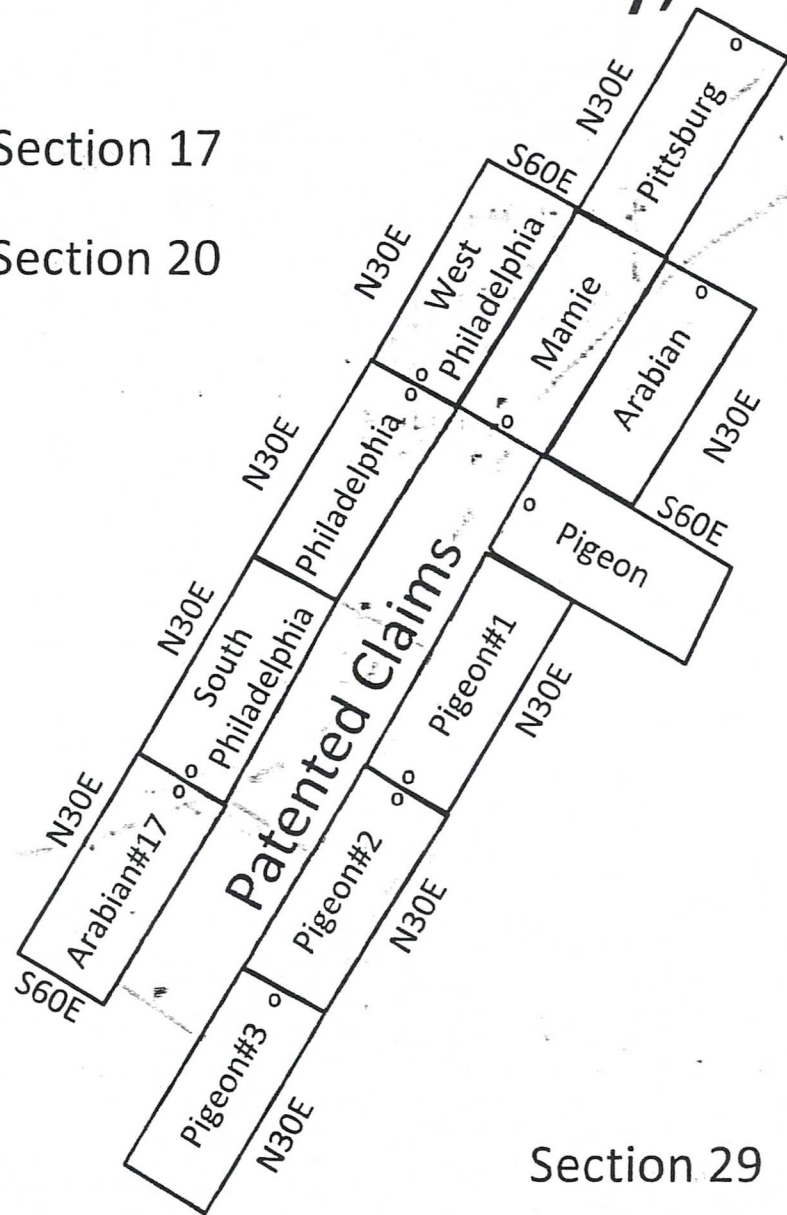

Section 19

Section 30

Section 29

PHOENIX, ARIZONA

2019 FEB 12 A 9: 59

RECEIVED  
PHOENIX STATE OFFICE

AMC453452

Thumb  
Butte



OFFICIAL RECORDS OF MOHAVE COUNTY KRISTI BLAIR, COUNTY RECORDER



02/11/2019 09:20 AM Fee: \$10.00

PAGE: 1 of 2

2

LOCATION NOTICE FOR LODE MINING CLAIM

Amendment BLM Serial #

NOTICE IS HEREBY GIVEN that the PIGEON #1

lode mining claim has been located

by John Pemberton whose current mailing

address is 4648 PATSY KINGMAN, AZ

86409

RECEIVED PHOENIX, ARIZONA 2019 FEB 12 A 9:50 PLM AZ STATE OFFICE BLM Date Stamp

The general course of this claim is N30E-S30W and it is situated in MOHAVE County, Arizona. This claim is 1500 feet in length and 600 feet in width.

20 Total Claim Acreage. This claim runs from the location monument on which this location notice is posted on the centerline of the claim approximately 10 feet in a S30W direction to the SW end line and 1490 feet in a N30E direction to the NE end line. This claim is marked by six monuments, one at each corner and one at the center of each end line of the claim.

The location monument on which this notice is posted is situated within Section 20, Township 21N, Range 20W, Gila Salt River Base and Meridian, Arizona and this claim encompasses portions of the following quarter section(s), section(s), Township(s) and Range(s) NE 1/4 and SE 1/4 SECTION 20, T21N, R20W

Gila Salt River Base and Meridian, Arizona.

The locality of this claim with reference to some natural object or permanent monument and additional information (if any) concerning its locality are as follows: APPROXIMATELY 4200 FT SW OF NE CORNER SECTION 20, T21N, R20W, EAST ADJACENT TO PATENTED CLAIMS

MS 3255 The above information is shown on the attached map.

DATED AND POSTED on the ground this 5th day of JANUARY, 2019.

LOCATOR(s) AGENT Print Name(s) JOHN Pemberton

Signature(s) John Pemberton

AMC453453

# T21N R20W GSR B&M Mohave County, Arizo

## Philadelphia Group Claims Location Map

scale  
  
1000 ft.

o = Location Monument

Section 17

Section 20

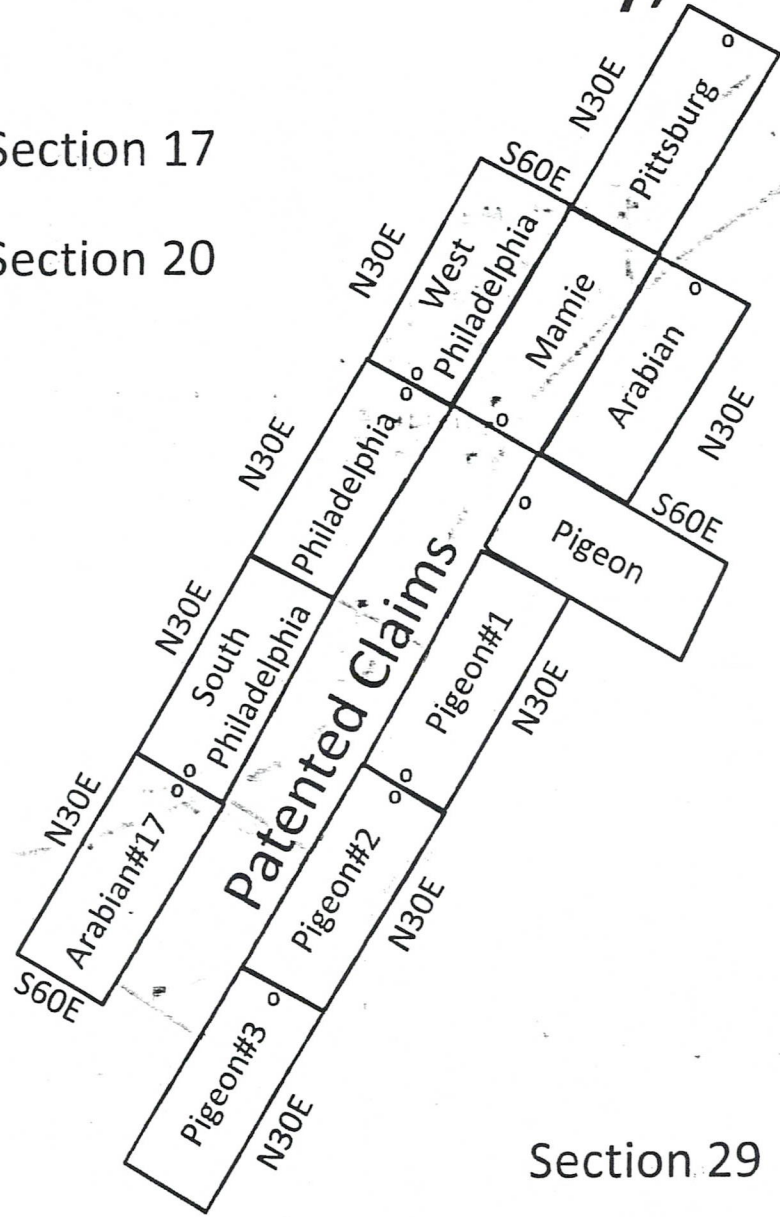

Section 19

Section 30

Section 29

PHOENIX, ARIZONA

2019 FEB 12 A 9: 59

RECEIVED  
AZ STATE OFFICE

AMC453453

Thumb  
Butte



OFFICIAL RECORDS OF MOHAVE COUNTY KRISTI BLAIR, COUNTY RECORDER



02/11/2019 09:20 AM Fee: \$10.00

PAGE: 1 of 2

2

LOCATION NOTICE FOR LODE MINING CLAIM

Amendment BLM Serial # NOTICE IS HEREBY GIVEN that the PIGEON #2 lode mining claim has been located by John Pemberton whose current mailing address is 4648 PATSY KINGMAN, AZ 86409

RECEIVED PHOENIX, ARIZONA 2019 FEB 12 A 9:59

The general course of this claim is N30E-S30W and it is situated in MOHAVE County, Arizona. This claim is 1500 feet in length and 600 feet in width.

20 Total Claim Acreage. This claim runs from the location monument on which this location notice is posted on the centerline of the claim approximately 10 feet in a N30E direction to the NE end line and 1490 feet in a S30W direction to the SW end line. This claim is marked by six monuments, one at each corner and one at the center of each end line of the claim.

The location monument on which this notice is posted is situated within Section 20, Township 21N, Range 20W, Gila Salt River Base and Meridian, Arizona and this claim encompasses portions of the following quarter section(s), section(s), Township(s) and Range(s) SE 1/4 and SW 1/4 SEC 20 T21N, R20W

Gila Salt River Base and Meridian, Arizona.

The locality of this claim with reference to some natural object or permanent monument and additional information (if any) concerning its locality are as follows: APPROXIMATELY 5300 FT. SW OF THE NE CORNER SEC. 20, T21N, R20W, EAST ADJACENT TO PATENTED CLAIMS MS 3255

The above information is shown on the attached map.

DATED AND POSTED on the ground this 5th day of JANUARY, 2019.

LOCATOR(s) AGENT Print Name(s) John Pemberton Signature(s) John Pemberton

AMC453454





FEE# 2019006517

OFFICIAL RECORDS OF MOHAVE COUNTY KRISTI BLAIR, COUNTY RECORDER



02/11/2019 09:20 AM Fee: \$10.00

PAGE: 1 of 2

2

LOCATION NOTICE FOR LODE MINING CLAIM

Amendment BLM Serial #

NOTICE IS HEREBY GIVEN that the PIGEON#3 lode mining claim has been located by John Pemberton whose current mailing address is 4648 PATSY, KINGMAN, AZ 86409

RECEIVED MAR 4 STATE OFFICE PHOENIX, ARIZONA 2019 FEB 12 A 9:59 BLM Date Stamp

The general course of this claim is N30E-S30W and it is situated in MOHAVE County, Arizona. This claim is 1500 feet in length and 600 feet in width.

20 Total Claim Acreage. This claim runs from the location monument on which this location notice is posted on the centerline of the claim approximately 10 feet in a N30E direction to the NE end line and 1490 feet in a S30W direction to the SW end line. This claim is marked by six monuments, one at each corner and one at the center of each end line of the claim.

The location monument on which this notice is posted is situated within Section 20, Township 21N, Range 20W, Gila Salt River Base and Meridian, Arizona and this claim encompasses portions of the following quarter section(s), section(s), Township(s) and Range(s) SW 1/4 SECTION 20 and NW 1/4 SECTION 29, T21N, R20W

Gila Salt River Base and Meridian, Arizona.

The locality of this claim with reference to some natural object or permanent monument and additional information (if any) concerning its locality are as follows: APPROXIMATELY 2000 FT. EAST OF NW CORNER SECTION 29, T21N, R20W, ADJACENT TO SE END OF PATENTED CLAIMS MS 3255

The above information is shown on the attached map.

DATED AND POSTED on the ground this 5th day of January, 2019.

LOCATOR(s) AGENT

Print Name(s) John Pemberton

Signature(s) John Pemberton

Form MCF100 Revised July 2014

AMC453455

# T21N R20W GSR B&M Mohave County, Arizo

## Philadelphia Group Claims Location Map

scale  
1000 ft.

o = Location Monument

Section 17

Section 20

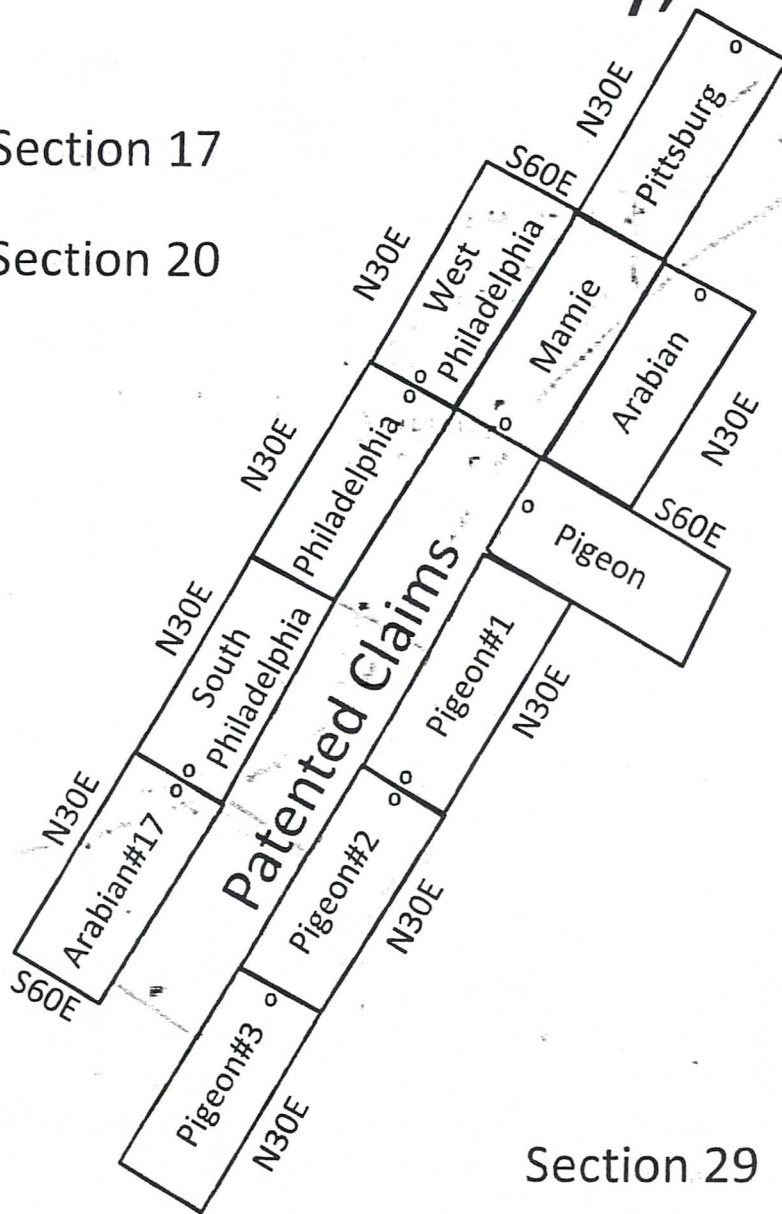

Section 19

Section 30

Section 29

PHOENIX, ARIZONA

2019 FEB 12 A 9: 59

RECEIVED  
STATE OFFICE

AMC453455

Thumb  
Butte



DEPARTMENT OF THE INTERIOR  
BUREAU OF LAND MANAGEMENT  
Case Recordation

Geographic Report with Land

Disposition is equal to **AUTHORIZED , CANCELLED , EXPIRED , PENDING , REJECTED , RELINQUISHED ,  
WITHDRAWN**

**and** Meridian Township Range Section is equal to **14 0210N 0200W 017 , 020 , 029**

**and** Admin State is equal to **AZ**

DEPARTMENT OF THE INTERIOR  
BUREAU OF LAND MANAGEMENT  
Case Recordation  
Geographic Report with Land

Admin State: AZ  
Geo State: AZ

Serial Number	Total Case Acres:	Casetype	Case Disp	Mer	Twp	Rng	Sec	Sur Type	Sur Nr	Suf	Subdivision	Act Pend
AZA 019989	25.570	286203	AUTHORIZED	14	0210N	0200W	017	ALIQ			SESE:	
AZA 035868	1.800	282101	PENDING					ALIQ			ALL:	Y
	1.800											
AZAR 0034112	244.540	282103	AUTHORIZED					ALIQ			SESE:	
AZAR 0034112AA	143.510	282103	AUTHORIZED					ALIQ			SESE:	
AZAR 0034826	28.790	286203	AUTHORIZED					ALIQ			SESE:	
AZPHX 0083786	236.625	285007	AUTHORIZED					ALIQ			SESE:	





